

1

2

3

4

A

B

C

D

E

F

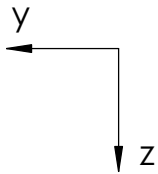
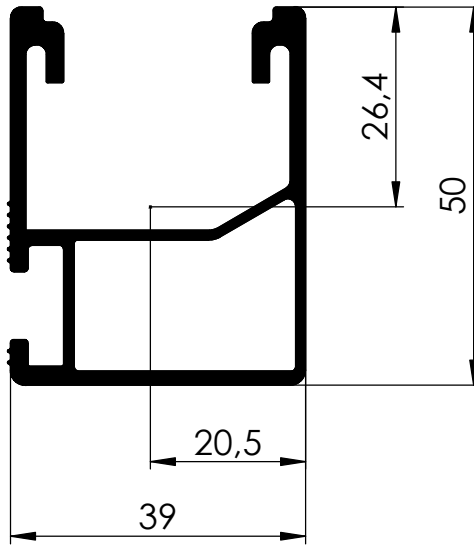

## Characteristics for calculation:

$$A = 3,69 \text{ cm}^2$$

$$I_y = 10,47 \text{ cm}^4$$

$$I_z = 8,46 \text{ cm}^4$$

$$W_y = 3,98 \text{ cm}^3$$

$$W_z = 4,23 \text{ cm}^3$$



K2 Systems GmbH  
Industriestr. 18  
71272 Renningen  
07159/42059-0

Designation:

Data sheet  
SingleRail 50 per meter

Name	Date	Material:	Item no.:	A4
Designed K. Mahboobi	11.09.2019	EN AW 6063 T66	2002459	
Approved B. Koch	11.09.2019	Surface: mill finish	Drawing no.: 01-109-03	All dimensions in mm
Last change S. Frey	07.09.2020	Weight: ca. 1002,2 g/m	Scale: 1:1	Sheet 1 of 1

This drawing is the sole property of K2 Systems GmbH. It is protected by copyright and may only be copied, reproduced or distributed to a third party with explicit permission!