



- The latest LED technology with a high luminous efficacy and a long service life
- Extremely high luminaire efficacy
- Can be adjusted from a 1.5 to a 3.0 h rated operating time
- Luminous flux after 100,000 h still 90% of the starting luminous flux
- Optionally with DALI for controlling and monitoring the luminaire
- Weekly functional test and annual rated operating time test

WebCode 6009D



The emergency luminaire with Series 6009/4 LED with integrated battery can be installed in stand-by switching, continuous mode or in switchable stand-by switching. A weekly functional test and annual rated operating time test are performed automatically. The results are indicated by an LED.

## Technical Data

### Explosion Protection

Ex version	Yes
Application range (zones)	1 2 21 22
IECEX gas certificate	IECEX IBE 16.0038
IECEX gas explosion protection	Ex db eb ib mb op is IIC T4 Gb
IECEX dust certificate	IECEX IBE 16.0038
IECEX dust explosion protection	Ex tb op is IIIC T100 °C Db
ATEX gas certificate	IBExU 16 ATEX 1199
ATEX gas explosion protection	⊕ II 2 G Ex db eb ib mb op is IIC T4 Gb
ATEX dust certificate	IBExU 16 ATEX 1199
ATEX dust explosion protection	⊕ II 2 D Ex tb op is IIIC T100 °C Db
EAC certificate	EAEU RU S-DE.HA91.B.00018/19
EAC dust explosion protection	⊕ Ex tb IIIC T100°C Db X
Certificates	ATEX (IBE), Brazil (ULB), China (CQST), EAC (ENDCE), IECEx (IBE), Japan (CML)
Ship approval	DNVGL

### Electrical Data

Rated operational voltage AC	100 – 240 V
Rated operational voltage max. AC	240 V
Rated operational voltage min. AC	100 V
Battery version	NiCd battery, gas-tight
Battery operating voltage	6 V
Battery capacity	7 Ah
Self-test function	With (standard)
Frequency range	50 – 60 Hz

### Lighting Data

Number of lamps	1
-----------------	---

# Lighting

## Emergency luminaire With LED

### GRP

6009/4148-2103-162-1110-11-850011 Art. No. 267872



#### Lighting Data

Lamp wattage	45 W
Lamp	LED
Light colour	Neutral white
Light distribution	120°x120° with diffusing glass
Luminaire efficacy	129 lm/W
Luminous flux	5810 lm
Operating time	1.5 / 3h emergency lighting operation
Emergency light output	20% ... 3 h 35% ... 1.5 h
Colour rendering	≥ 80
Colour temperature	5000 K

#### Ambient Conditions

Ambient temperature	-30 °C ... +50 °C Note: Through wiring max. 3x16 A -30 °C ... +55 °C Note: Through wiring 2 max. 3x10 A
---------------------	------------------------------------------------------------------------------------------------------------

#### Mechanical Data

Version	Standard
Degree of protection IP (IEC 60598)	IP66/IP67
Enclosure material	Polyester resin, Glass fibre reinforced
Diffuser	With diffuser
Sealing material	Silicone
Silicon free	Contains silicone
Material translucent cover	Polycarbonate
Installed terminal strip	PE + N + L1 + L2 + L3 + L´
Connection terminals solid max.	6 mm <sup>2</sup>
Connection terminals finely-stranded max.	4 mm <sup>2</sup>
Type of connection cable	Finely stranded Solid
Design size	4
Width	183.5 mm
Height	125 mm
Length	1467 mm
Impact strength (IEC 62262)	IK10
Enclosure colour	Light grey (RAL 7035)
Weight	9.2 kg
Weight	20.28 lb
Disconnection of the luminaire	All-pole disconnection

#### Components

Threaded plate	2x plastic
Ballast	6046/211-121-010 LED NLE 7Ah
Through wiring	With 6 conductors 2.5 mm <sup>2</sup>
Drilled holes	3 x M25
Cable entries	2 x M25 Ø 7 – 17 mm
Material cable gland	Polyamide, black
Stopping plug	2 x M25 x 1.5

#### Components

Stopping plug material	Polyamide, black
Accessories	Provided

#### Dimensional Drawings (All Dimensions in mm [inches]) – Subject to Alterations

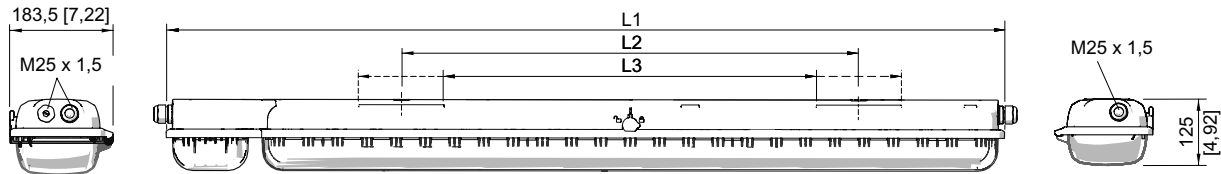

Size 2:  
 L1 = 857 mm [33.74]  
 L2 = 400 mm [15.75]  
 L3 = 320 ... 480 mm [12.60 ... 18.90]

Size 4:  
 L1 = 1467 mm [57.76]  
 L2 = 800 mm [31.50]  
 L3 = 670 ... 930 mm [26.38 ... 36.61]

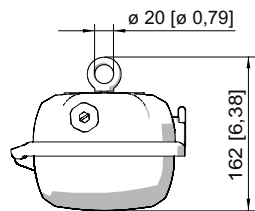

Ring bolt fitted in insert nut of the luminaire

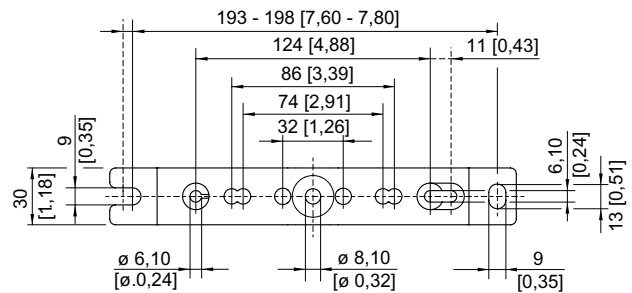
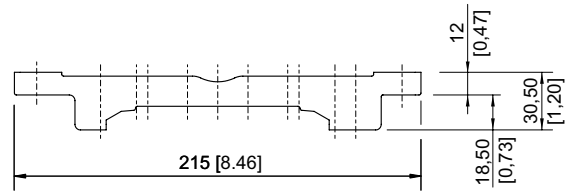

Mounting rail

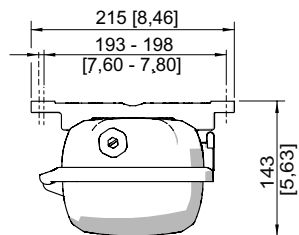

Mounting rail

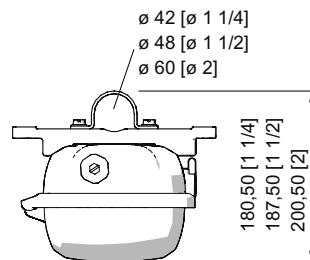

Pipe clamp fitted in mounting rail

# Lighting

Emergency luminaire With LED

GRP

6009/4148-2103-162-1110-11-850011 Art. No. 267872

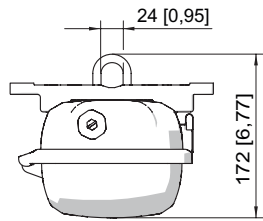

Mounting bracket fitted in mounting rail

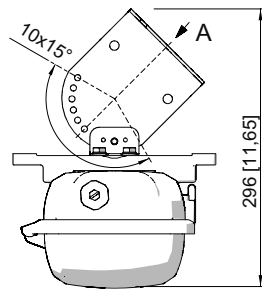

A

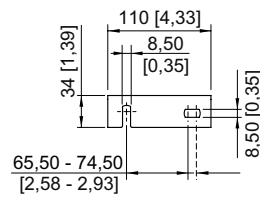

Wall mounting bracket fitted in mounting rail

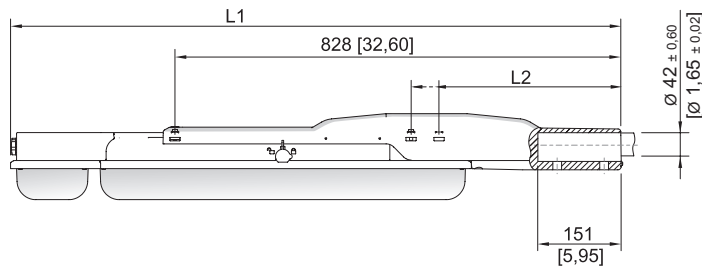

With pole mounting sleeve

Size 2:

L1 = 1133 mm [44.61]

L2 = 390 mm [15.35]

Size 4:

L1 = 1742 mm [68.58]

L2 = 338 mm [13.31]

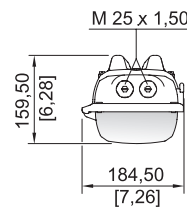

## Accessories

### Socket key

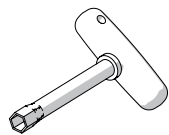

M8 / wrench size 13;  
to open/close the central locking

Art. No.

222430

### Mounting rail

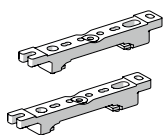

for a variable mounting distance; 1 pair

Art. No.

222826

### Mounting bracket

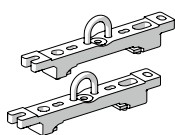

mounting clamp mounted on a mounting rail for a variable mounting distance; 1 pair

Art. No.

222456

# Lighting

## Emergency luminaire With LED

GRP

6009/4148-2103-162-1110-11-850011 Art. No. 267872

STAHL

### Pole mounting sleeve

Art. No.



for the subsequent mounting on lights size 2 and size 4, completely with assembly parts (for pipe diameter 42 mm)

227512

### Pipe clamp

Art. No.

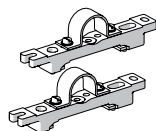

R 1 1/2"; with mounting rail for a variable mounting distance; Material: stainless steel; 1 pair

222459

R 1 1/4"; with mounting rail for a variable mounting distance; Material: stainless steel; 1 pair

222458

R 2"; with mounting rail for a variable mounting distance; Material: stainless steel; 1 pair

222460

### Ring bolt

Art. No.



M8, direct mounting in insert nuts; 1 pair

115736

### Breather

Art. No.

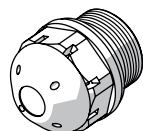

Thread: M25 x 1.5; 1 pc; for installation in lights; in moulded material; without counter nut

138573

Thread: M25 x 1.5; 20 pc; for installation in lights; in moulded material; without counter nut

138576

M25 x 1.5 in order to avoid condensate formation

115738

### Ceiling and wall mounting bracket

Art. No.

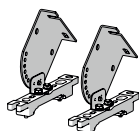

mounted on a mounting rail for a variable mounting distance; Material: stainless steel; Lamp can be swiveled in steps of 15°; 1 pair

222827

## Spare Parts

### Cover

Art. No.

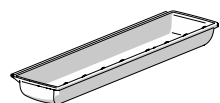

for luminaire size 4

222428

### Contact element

Art. No.

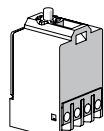

8080/1-3-L 2 NC contact element

132527

### Battery set

Art. No.

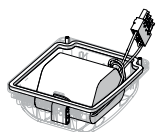

Battery cover with built-in battery. Gas-tight NiCd battery; 7 Ah / 6 V

223532

We reserve the right to make alterations to the technical data, dimensions, weights, designs and products available without notice. The illustrations cannot be considered binding.