

THIS COPY IS PROVIDED ON A RESTRICTED BASIS AND IS NOT TO BE USED IN ANY WAY DETRIMENTAL TO THE INTERESTS OF PANDUIT CORP.

PANDUIT PART NO.	MAX BUNDLE DIA.	PACKAGE QTY	LENGTH "L" ±.3 [ 7 ]
MLT2.7WS-LP	2.7" [ 69 ]	50	10.2" [ 259 ]
MLT4WS-LP	4" [ 102 ]	50	14.3" [ 362 ]
MLT6WS-LP	6" [ 152 ]	50	20.5" [ 521 ]
MLT8WS-LP	8" [ 203 ]	50	20.8" [ 679 ]
MLT4WS-TL	4" [ 102 ]	250	14.3" [ 362 ]

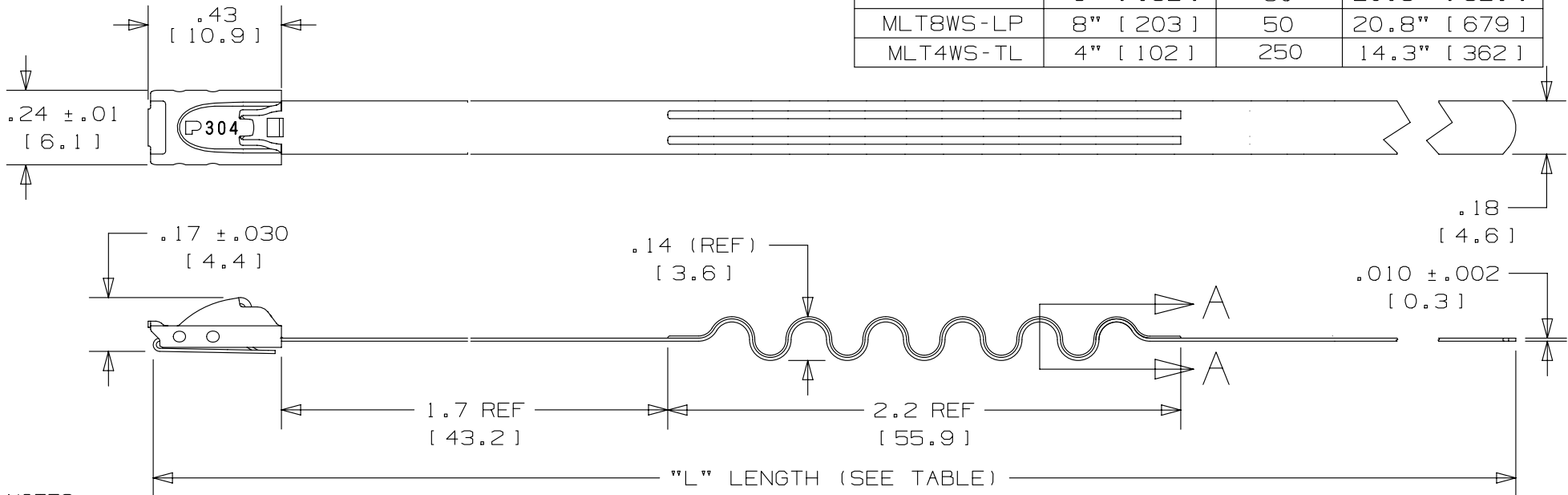

- NOTES:
1. APPLICATION TOOLS - GS4MT,PPTMT,ST2MT,ST3MT,HTMT
  2. MINIMUM LOOP TENSILE STRENGTH - 200 LBS (890 NEWTONS) WHEN TESTED ON A 3" MANDREL. PART NO. MLT2.7WS-LP TESTED ON A 1 1/2" MANDREL.
  3. BRACKETS [ ] DENOTE DIMENSIONS IN MILLIMETERS, AND ARE SHOWN FOR REFERENCE ONLY
  4. TOLERANCES:  
 .XXX = ±.010 [ .25 ]    .XX = ±.02 [ .5 ]  
 .X = ±.03 [ .8 ]        ANGLES = ±2°
  5. MATERIAL: 304 STAINLESS STEEL

FULLY ROUNDED EDGES ALONG STRAP BODY

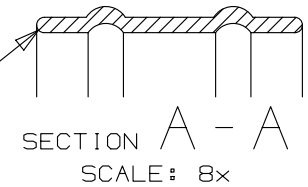

REV	DATE	BY	CHK	APR	DESCRIPTION	ECN
10A	3/13	JAMB	MIM	RGRO	UPDATE DRAWING TO NEW GLOBAL PANDUIT TITLE BLOCK WITH PANDUIT LOGO	SSECN01037
09A	1/13	JAMB	RGRO	---	ADDED PART NUMBER MLT4WS-TL TO DRAWING	-----
08A	2/12	MIM	RGRO	---	NOTE #3 METRIC DIMENSIONS NOTED AS BEING SHOWN FOR REFERENCE ONLY	-----

TITLE	
WAVE-TY STANDARD SERIES 304 STAINLESS STEEL CUSTOMER DRAWING	
ITEM REVISION NAME	N41124BS/10
DATASET FILE NAME	N41124BS_DC/10A
UNLESS OTHERWISE SPECIFIED, DIMENSIONAL TOLERANCES ARE: IN [ mm ]	MATERIAL: 304 STAINLESS STEEL
.x ± .1 [ 2.54 ]    .xxx ± .005 [ .127 ]	DRAWING NUMBER: N41124BS_DC
.xx ± .01 [ .25 ]    ANGLES ± 5 °	
	THIRD ANGLE PROJECTION
DRAWN BY	JAMB
DATE	02/12
CHK	DPN
SCALE	2:1
SHT 1 OF 1	
SIZE	A