

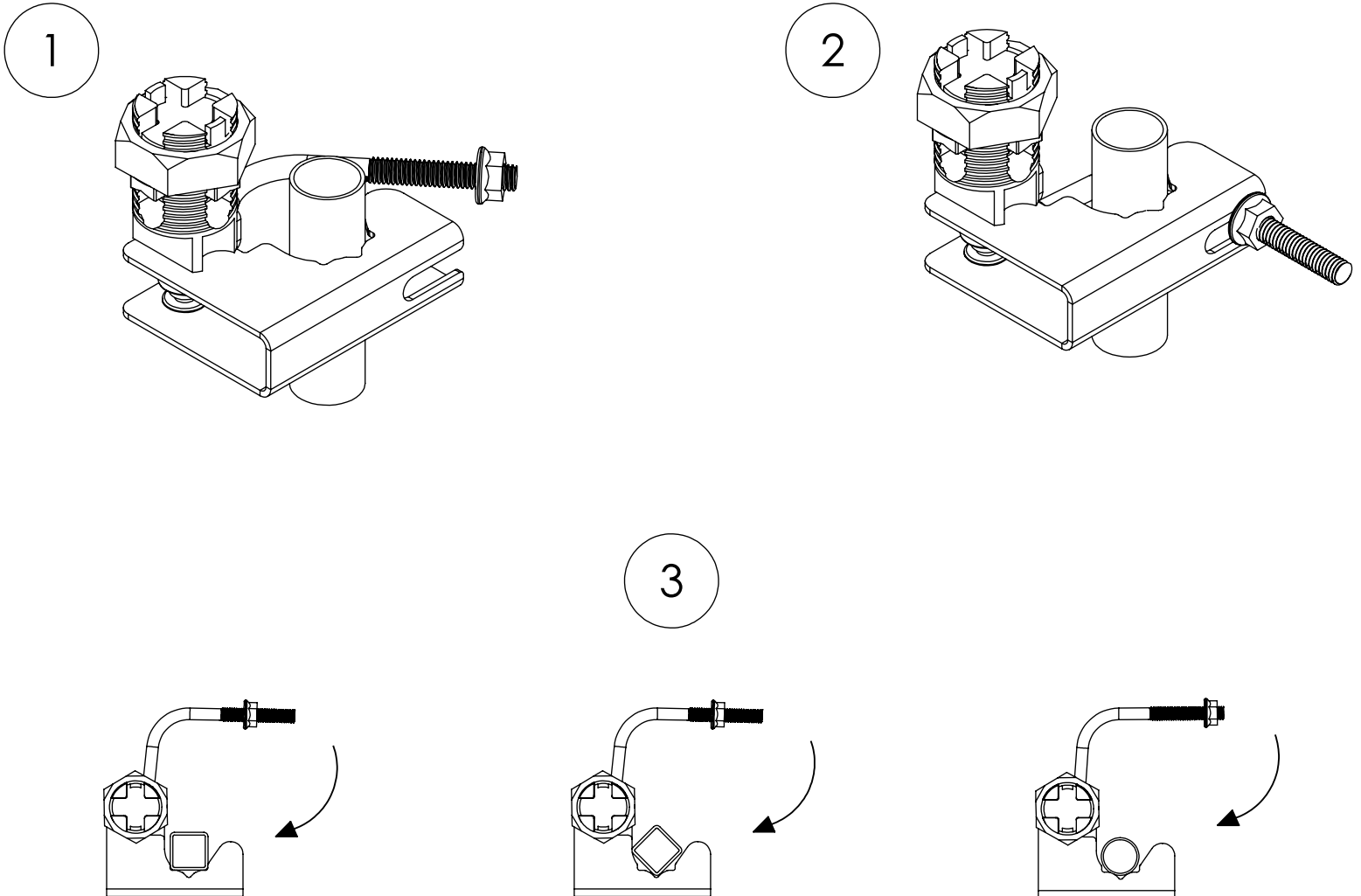

| PART NUMBER | PEDESTAL SIZE & TYPE |
|-------------|---------------------------------------|
| GPQC07-1/0 | 3/4" ROUND 7/8" ROUND |
| GPQC10-1/0 | 7/8" SQUARE 1" ROUND, 1-1/8" ROUND |
| GPQC12-1/0 | 1-1/4" ROUND |
| GPQC15-1/0 | 1-1/2" ROUND |
| GPQC17-1/0 | 1-3/4" ROUND |
| GPQC20-1/0 | 2" ROUND |

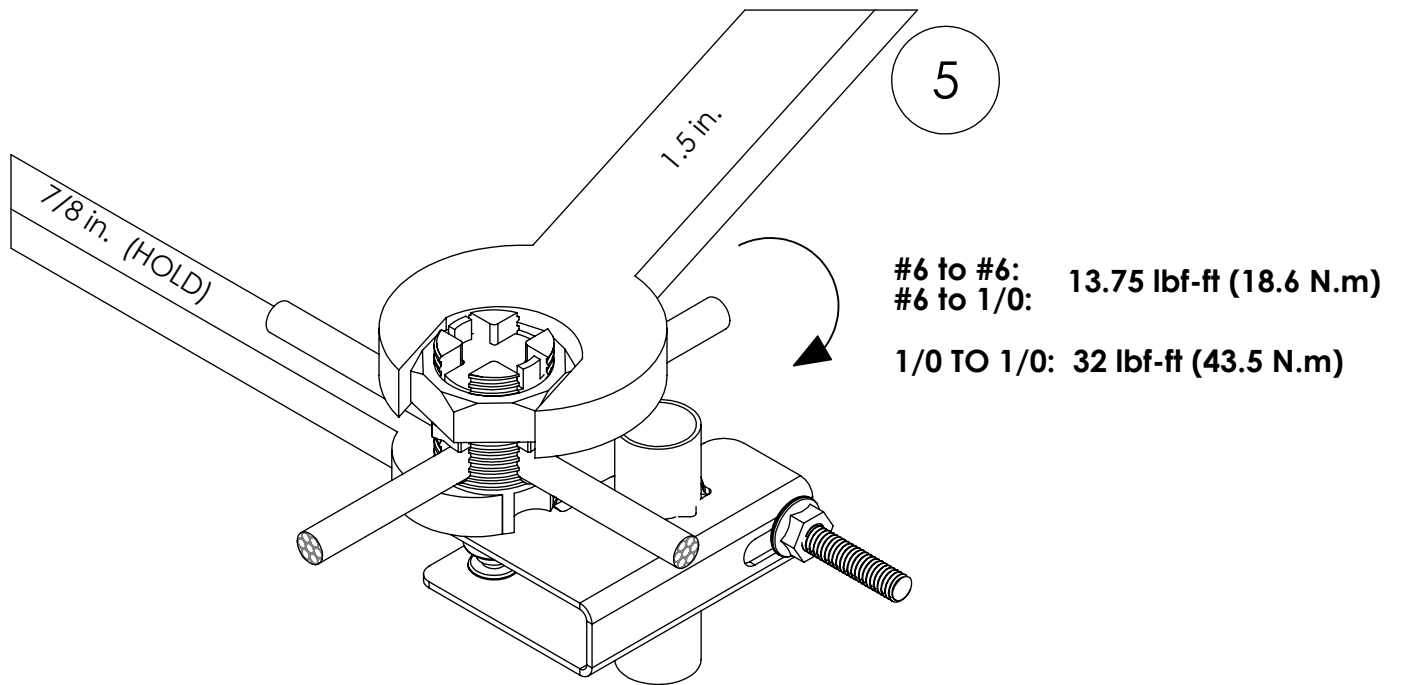

* GPQC10-1/0 SHOWN FOR REFERENCE

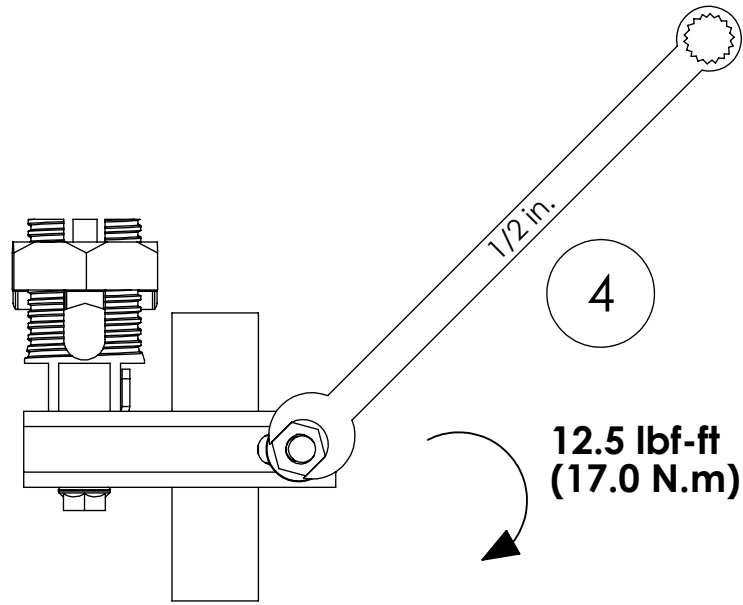

The pedestal bonded to the clamp is not intended to serve as a grounding conductor.