

panel mounting socket outlet, straight - flange 75x75, fixing centers 60x60

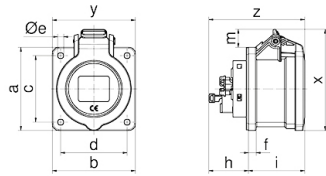

Product description	
BALS-Prd.-Nr	136851
EAN	4024941379281
Product category	Panel mounting socket outlet INNOLINQ QUICK-CONNECT straight
Current	16A
Number of poles	3p
Arrangement of phases	2P+PE
Position of earth contact	4 h
Voltage	100 - 130V~

Product description	
Frequency	50/60Hz
Protection degree	IP54
Colour code	yellow RAL 1012
Colour of appliance	Hinged lid yellow RAL 1012, Enclosure grey RAL 7035
Connection design	screwless spring terminals with KONTEX-ULTRA contact
Maximum conductor size	4,0 qmm
Cable entry	other
Height	79mm
Width	75mm
Depth	86mm
Flange size vertical in mm	75mm
Flange size horizontal in mm	75mm
Drill hole dist. vertical mm	60mm
Drill hole dist. horizontal mm	60mm
Material of enclosure	Polyamide
Contacts	The contact carrier is made of polyamide, The contacts are brass



Einbauöffnung



4MB502

Ampere Poles	16 3	16 5	32 5
a	75,0	75,0	75,0
b	75,0	75,0	75,0
c	60,0	60,0	60,0
d	60,0	60,0	60,0
Øe	5,5	5,5	5,5
f	7,0	7,0	7,0
h	36,0	36,0	46,0
i	50,0	51,0	62,0
Øl	45,0	55,0	60,0
m	8,0	16,5	23,5
x	83,0	92,0	105,0
y	75,0	75,0	75,5
z	86,0	87,0	108,0

