

FAGERHULT

SE - 566 80 Habo

Discovery Evo

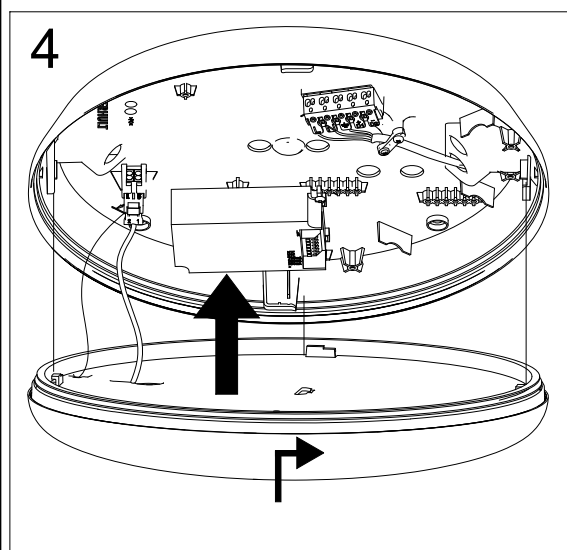
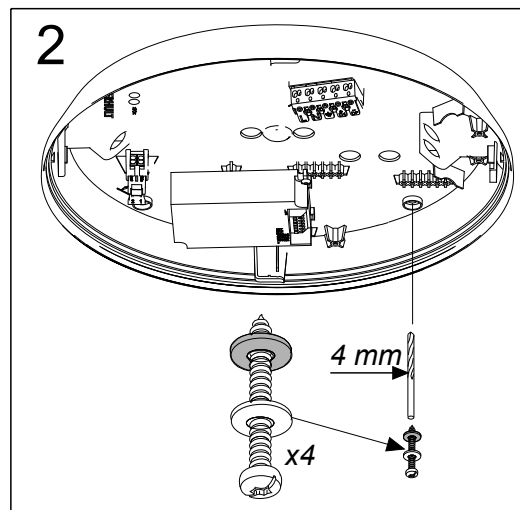
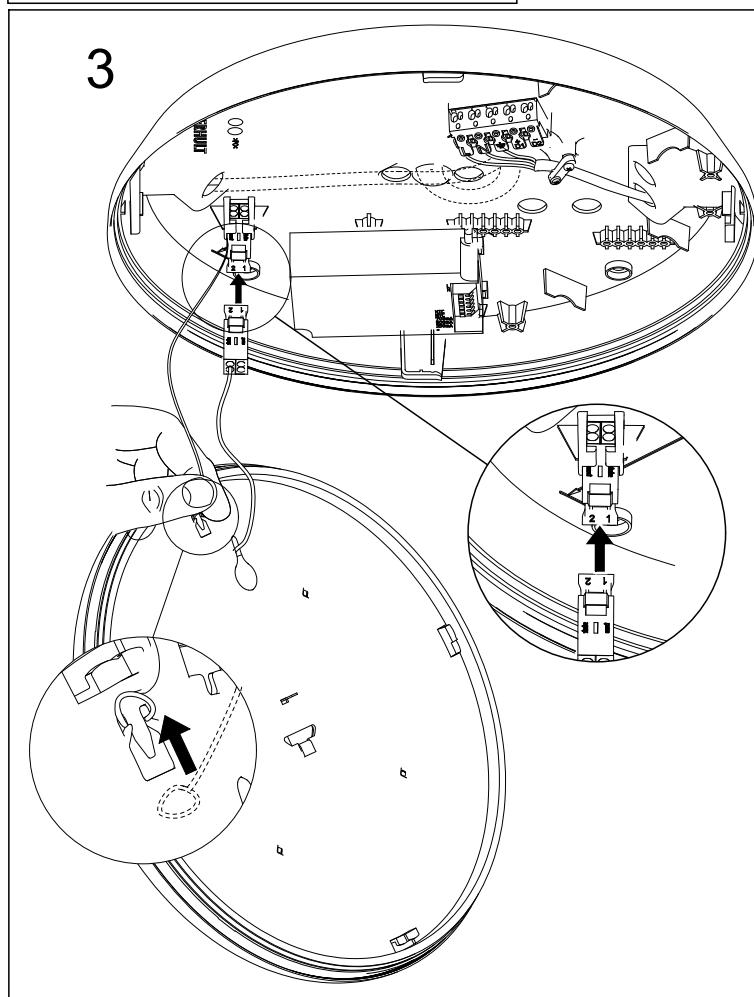
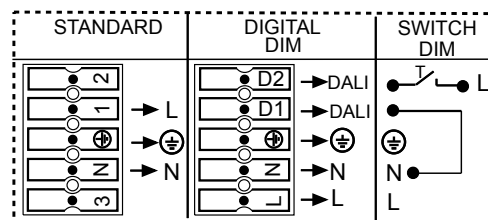
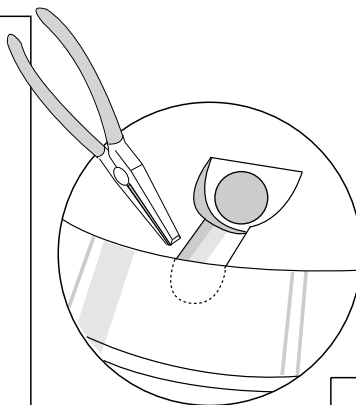
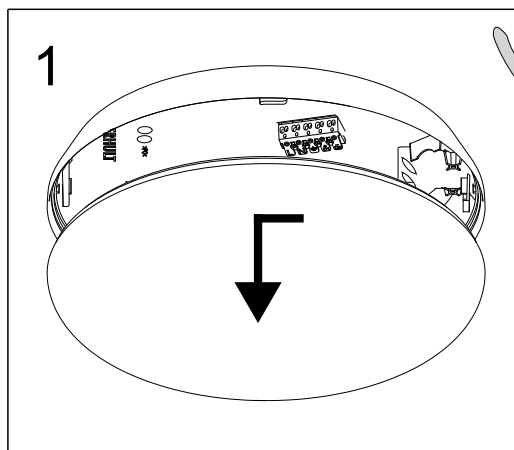
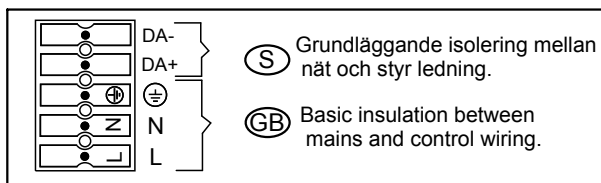
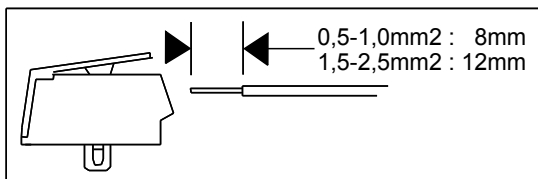
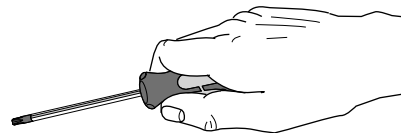
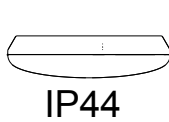

(S) Det är lämpligt att denna information överlämnas till användaren av anläggningen.

(GB) It is appropriate that this information is passed on to the users of the installation.

(D) Diese Informationen sind für den Benutzer der Anlage vorgesehen.

(SF) Nämä ohjeet tulee säilyttää ja luovuttaa kiinteistön käyttäjälle.

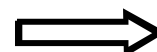

Emergency

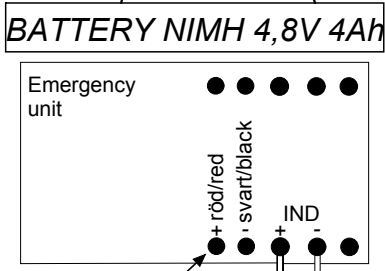
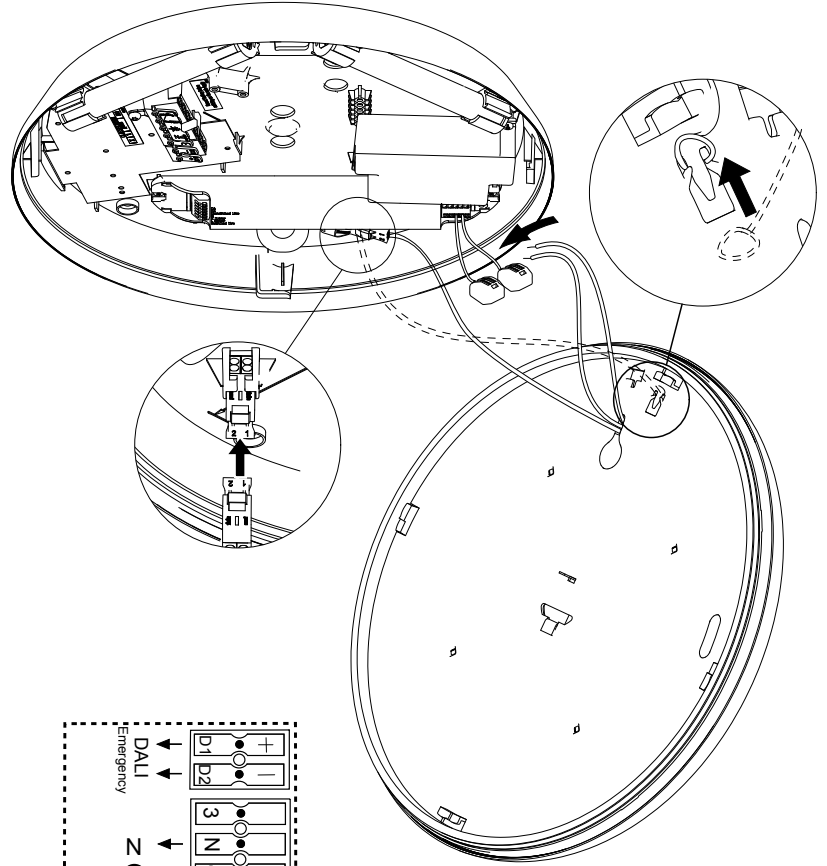
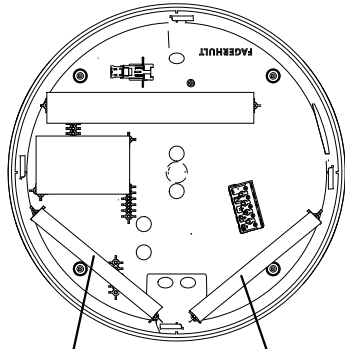
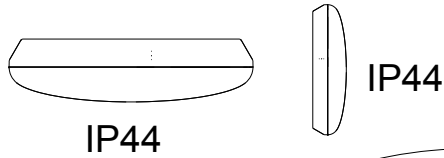

Red cable from batteri
remove from clamp and
connect to emergency unit

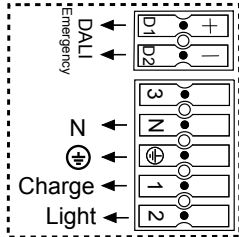

E-sense Brightswitch ON/OFF

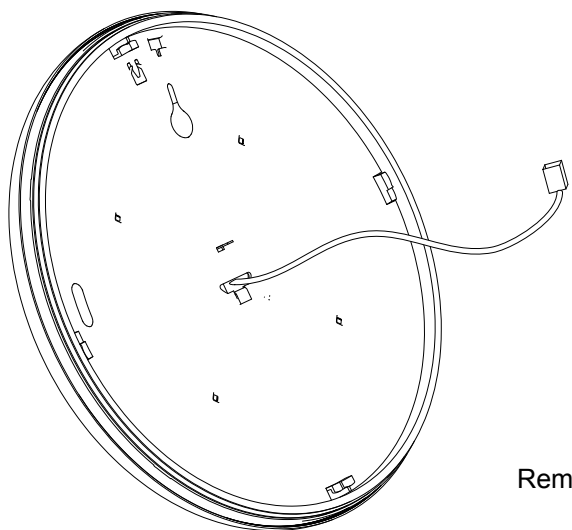
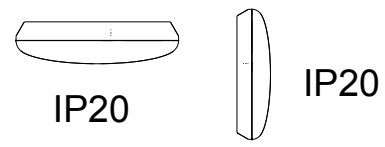

Remote controll e-Sense brigthswitch 86359

5007580 Utgåva/Edition 04

- (S) Det är lämpligt att denna information överlämnas till användaren av anläggningen.
- (D) Diese Informationen sind für den Benutzer der Anlage vorgesehen.
- (GB) It is appropriate that this information is passed on to the users of the installation.
- (SF) Nämä ohjeet tulee säilyttää ja luovuttaa kiinteistön käyttäjälle.



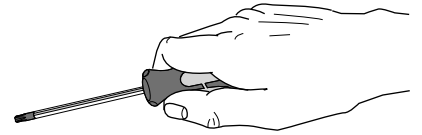

Discovery Evo Recessed kit IP44

92656 tillbehör/ accessories

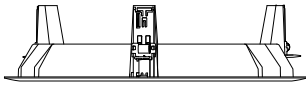

1 Ø 380mm

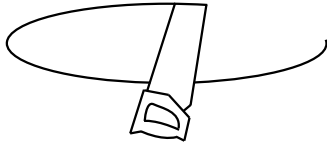

92652 tillbehör/ accessories



For installing in suspended ceilings.



För montering i mjuka tak.

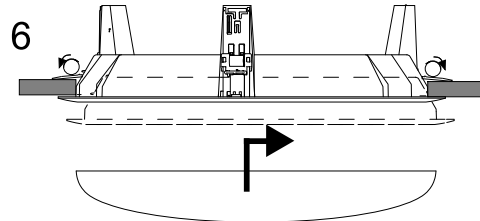
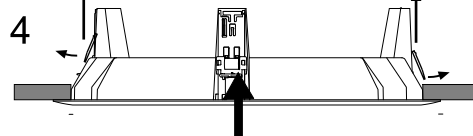
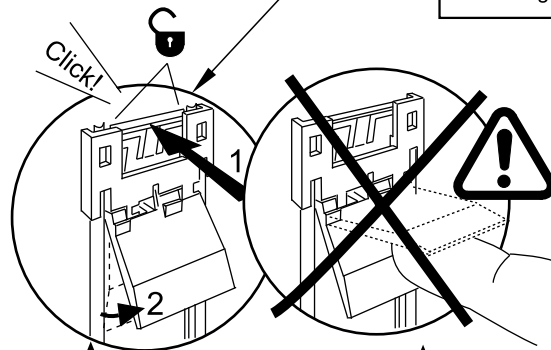
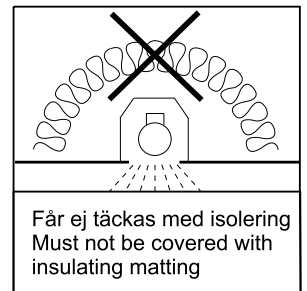
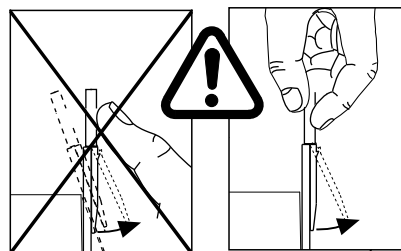
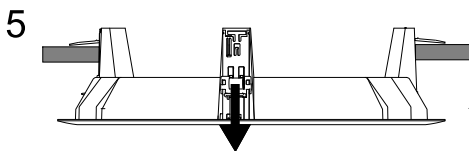
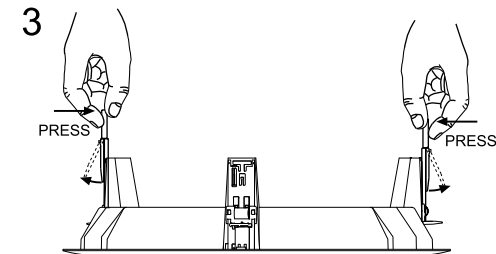
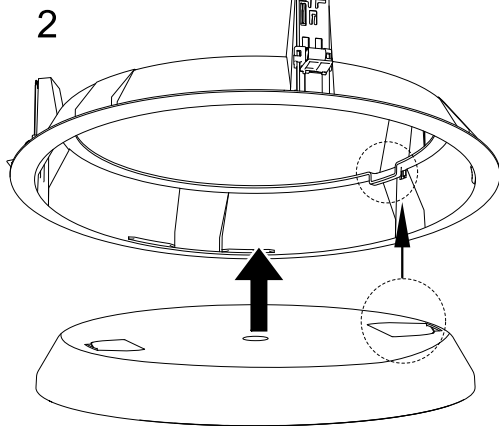

Remove Procedure

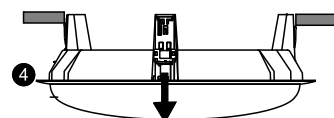
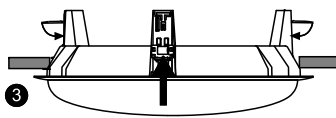
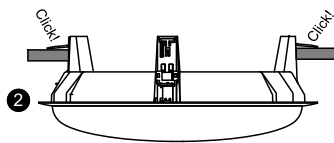
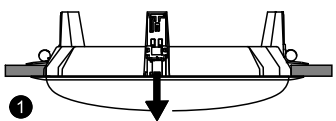

Smartswitch	Others
IP20	IP44

S För montering i ventilerat alternativt oventilerat utrymme.

GB For mounting in ventilated or unventilated spaces

S Det är lämpligt att denna information överlämnas till användaren av anläggningen.

GB It is appropriate that this information is passed on to the users of the installation.

D Diese Informationen sind für den Benutzer der Anlage vorgesehen.

SF Nämä ohjeet tulee säilyttää ja luovuttaa kiinteistön käyttäjälle.