

# Lighting

## Emergency luminaire For fluorescent lamps

GRP

6009/522-9617-1611-71 Art. No. 225723



- Can be used in Zones 1, 2, 21 and 22
- Two fluorescent lamps: 18 W and 36 W
- Weekly function test and annual emergency light duration test

WebCode 6009A



The 6009 series EXLUX emergency luminaire is suitable for use as safety lighting. It is lightweight and requires minimal maintenance. The battery is housed in the external enclosure and powers the emergency lighting for 1.5 or 3 hours. If one lamp is faulty, the luminaire switches to the working lamp. When the central lock is opened, the luminaire is always disconnected from the power supply at all poles.

### Technical Data

#### Explosion Protection

Ex version	Yes
Application range (zones)	1 2 21 22
IECEX gas certificate	IECEX PTB 13.0059
IECEX gas explosion protection	Ex db eb mb IIC T4 Gb
IECEX dust certificate	IECEX PTB 13.0059
IECEX dust explosion protection	Ex tb IIIC T80 °C Db
ATEX gas certificate	PTB 13 ATEX 2015
ATEX gas explosion protection	⊕ II 2 G Ex db eb mb IIC T4 Gb
ATEX dust certificate	PTB 13 ATEX 2015
ATEX dust explosion protection	⊕ II 2 D Ex tb IIIC T80 °C Db
EAC certificate	EAEU RU C-DE.HA91.B.00061/19
EAC gas explosion protection	⊕ 1 Ex d e mb IIC T4 Gb
EAC dust explosion protection	⊕ Ex tb IIIC T80°C Db
Certificates	ATEX (PTB), Brazil (ULB), China (CQST), EAC (ENDCE), IECEX (PTB), India (PESO), Polen (CNBOP)
Ship approval	DNV GL

#### Electrical Data

Rated operational voltage AC	220 – 240 V
Rated operational voltage max. AC	240 V
Rated operational voltage min. AC	220 V
Battery version	NiCd battery, gas-tight
Battery operating voltage	6 V
Battery capacity	7 Ah

# Lighting

## Emergency luminaire For fluorescent lamps

### GRP

6009/522-9617-1611-71 Art. No. 225723



#### Electrical Data

Self-test function	With (standard)
Frequency range	50 – 60 Hz

#### Lighting Data

Number of lamps	2
Lamp wattage	18 W
Lamp	G13 lamp base
Luminaire efficacy	0 lm/W
Luminous flux	0 lm
Operating time	1.5 / 3h emergency lighting operation
Emergency light mode	Continuous light Or stand-by light
Emergency light output	100% - 1.5 h 60% - 3 h
Colour temperature	0 K

#### Ambient Conditions

Ambient temperature	-30 °C ... +50 °C Note: Through wiring max. 3x16 A -30 °C ... +55 °C Note: Through wiring 2 Max. 3x8 A
---------------------	---

#### Mechanical Data

Version	Standard
Degree of protection IP (IEC 60598)	IP66 / IP67
Class	I (with inner PE connection)
Enclosure material	Polyester resin, Glass fibre reinforced
Sealing material	Silicone
Silicon free	Contains silicone
Material translucent cover	Polycarbonate
Installed terminal strip	PE + N + L1 + L2 + L3 + L´
Connection terminals solid max.	6 mm <sup>2</sup>
Connection terminals finely-stranded max.	4 mm <sup>2</sup>
Lighting lock	Central lock , For box spanner actuation
Type of connection cable	Finely stranded Solid
Design size	2
Width	183.5 mm
Height	125 mm
Length	857 mm
Impact strength (IEC 62262)	IK10
Enclosure colour	Light grey (RAL 7035)
Weight	7.6 kg
Weight	16.76 lb
Disconnection of the luminaire	All-pole disconnection

#### Components

Threaded plate	2x plastic
Ballast	6043/792-201
Through wiring	With 6 conductors 2.5 mm <sup>2</sup>
Battery-Version	NiCd battery, gas-tight

#### Components

Drilled holes	3 x M25
Cable entries	2 x M25 Ø 7 – 17 mm
Material cable gland	Polyamide, black
Stopping plug	2 x M25 x 1.5
Stopping plug material	Polyamide, black
Accessories	Provided

#### Dimensional Drawings (All Dimensions in mm [inches]) – Subject to Alterations

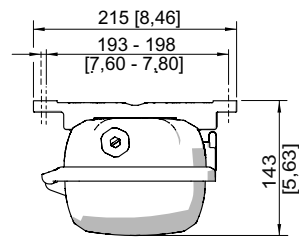
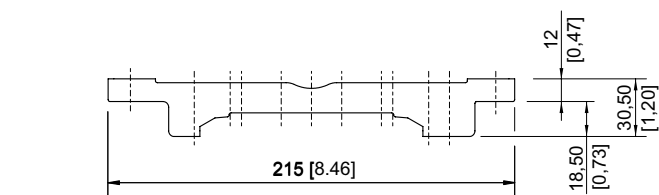

Mounting rail

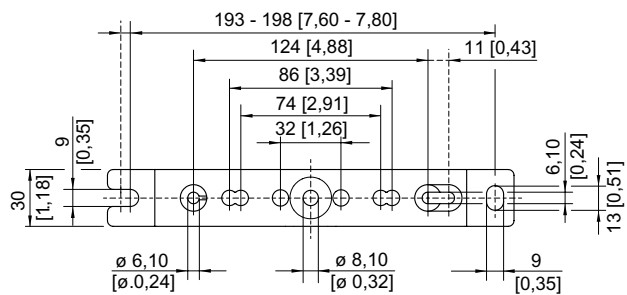

Mounting rail

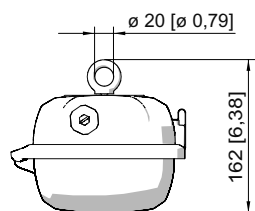

Ring bolt fitted in insert nut of the luminaire

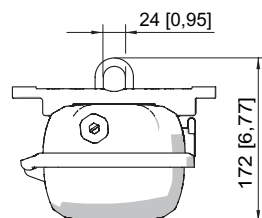

Mounting bracket fitted in mounting rail

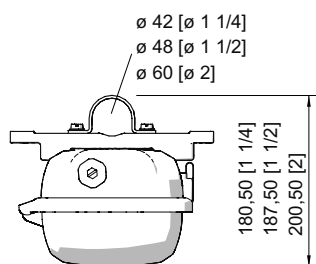

Pipe clamp fitted in mounting rail

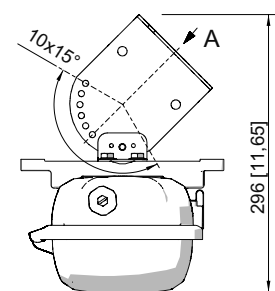

A

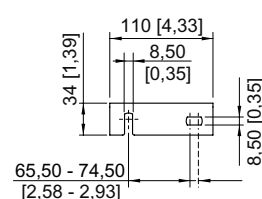

Wall mounting bracket fitted in mounting rail

# Lighting

Emergency luminaire For fluorescent lamps

GRP

6009/522-9617-1611-71 Art. No. 225723

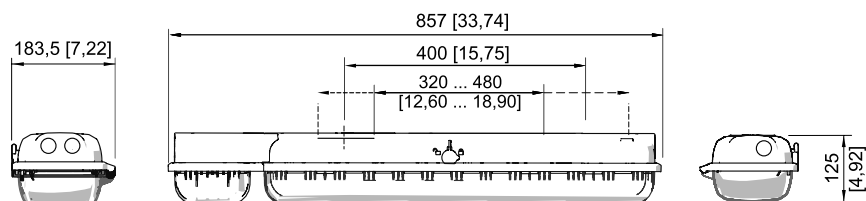

Size 2

## Accessories

### Breather

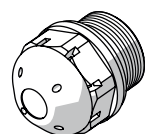

	Art. No.
Thread: M25 x 1.5; 1 pc; for installation in lights; in moulded material; without counter nut	138573
Thread: M25 x 1.5; 20 pc; for installation in lights; in moulded material; without counter nut	138576

### Ceiling and wall mounting bracket

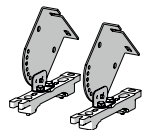

	Art. No.
mounted on a mounting rail for a variable mounting distance; Material: stainless steel; Lamp can be swiveled in steps of 15°; 1 pair	222827

### Mounting bracket

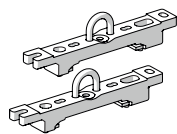

	Art. No.
mounting clamp mounted on a mounting rail for a variable mounting distance; 1 pair	222456

### Mounting rail

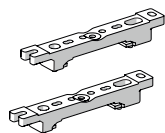

	Art. No.
for a variable mounting distance; 1 pair	222826

### Pipe clamp

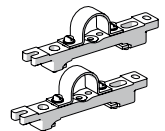

	Art. No.
R 1 1/2"; with mounting rail for a variable mounting distance; Material: stainless steel; 1 pair	222459
R 1 1/4"; with mounting rail for a variable mounting distance; Material: stainless steel; 1 pair	222458
R 2"; with mounting rail for a variable mounting distance; Material: stainless steel; 1 pair	222460

### Pole mounting sleeve



	Art. No.
for the subsequent mounting on lights size 2 and size 4, completely with assembly parts (for pipe diameter 42 mm)	227512

### Ring bolt



	Art. No.
M8, direct mounting in insert nuts; 1 pair	115736

# Lighting

Emergency luminaire For fluorescent lamps

GRP

6009/522-9617-1611-71 Art. No. 225723



## Socket key

Art. No.

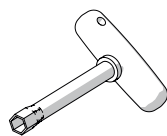

M8 / wrench size 13;  
to open/close the central locking

222430

## Spare Parts

### Battery set

Art. No.

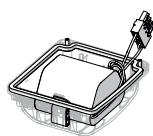

Battery cover with built-in battery. Gas-tight NiCd battery; 7 Ah / 6 V

223532

### Contact element

Art. No.

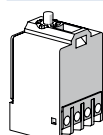

8080/1-3-L 2 NC contact element

132527

### Cover

Art. No.

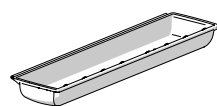

for luminaire size 2

222427

### Fluorescent lamp

Art. No.

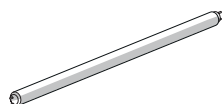

18 W, 1350 lm

108952

### Lamp holder

Art. No.

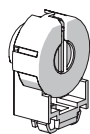

G13 Ex e lamp holder for light fittings with T8 fluorescent lamps for use in Zone 1

117252

We reserve the right to make alterations to the technical data, dimensions, weights, designs and products available without notice. The illustrations cannot be considered binding.