

Lighting

Linear luminaire For fluorescent lamps

GRP

6001/542-9510-15-131 Art. No. 220903



- Can be used in Zone 1, 2, 21 and 22
- Extremely robust: Impact strength rating of IK10

WebCode 6001A



The 6001 EXLUX luminaire is suited to normal lighting applications in almost any facility. In no time at all and with very little effort, using the accessories it can be fitted to the wall, ceiling or a pole, or alternatively, it can be suspended. The practical central lock has a safety switch that disconnects the power supply at all poles when the plastic enclosure is opened. Lightweight yet strong: The high-quality workmanship makes this luminaire robust and minimises maintenance requirements.

Technical Data

Explosion Protection

Ex version	Yes
Application range (zones)	1 2 21 22
IECEX gas certificate	IECEX PTB 13.0003
IECEX gas explosion protection	Ex db eb IIC T4 Gb
IECEX dust certificate	IECEX PTB 13.0003
IECEX dust explosion protection	Ex tb IIIC T80 °C Db
ATEX gas certificate	PTB 13 ATEX 2004
ATEX gas explosion protection	⊕ II 2 G Ex db eb IIC T4 Gb
ATEX dust certificate	PTB 13 ATEX 2004
ATEX dust explosion protection	⊕ II 2 D Ex tb IIIC T80 °C Db
EAC certificate	EAEU RU C-DE.HA91.B.00060/19
EAC gas explosion protection	⊕ 1 Ex d e IIC T4 Gb
EAC dust explosion protection	⊕ Ex tb IIIC T80°C Db
Certificates	ATEX (PTB), Brazil (ULB), China (CQST), EAC (ENDCE), IECEX (PTB), India (PESO), Polen (CNBOP), Taiwan (ITRI)
Ship approval	DNV GL

Electrical Data

Rated operational voltage AC	220 – 240 V
Rated operational voltage DC	220 – 240 V
Frequency range	50 – 60 Hz

Lighting Data

Number of lamps	2
Lamp wattage	36 W

Lighting

Linear luminaire For fluorescent lamps

GRP

6001/542-9510-15-131 Art. No. 220903



Lighting Data

Lamp	G13 lamp base
Luminaire efficacy	0 lm/W
Luminous flux	0 lm
Colour temperature	0 K

Ambient Conditions

Ambient temperature	-30 °C ... +50 °C Note: Through wiring max. 3x16 A -30 °C ... +55 °C Note: Through wiring 2 max. 3x10 A
---------------------	--

Mechanical Data

Version	Standard
Degree of protection IP (IEC 60598)	IP66/IP67
Class	I (with inner PE connection)
Enclosure material	Polyester resin, Glass fibre reinforced
Sealing material	Silicone
Silicon free	Contains silicone
Material translucent cover	Polycarbonate
Installed terminal strip	PE + N + L1 + L2 + L3
Connection terminals solid max.	6 mm ²
Connection terminals finely-stranded max.	4 mm ²
Lighting lock	Central lock , For box spanner actuation
Type of connection cable	Finely stranded Solid
Design size	4
Width	184 mm
Height	125 mm
Length	1310 mm
Impact strength (IEC 62262)	IK10
Enclosure colour	Light grey (RAL 7035)
Weight	6.75 kg
Weight	14.88 lb
Disconnection of the luminaire	Yes

Components

Threaded plate	2x plastic
Ballast	6042/243-21
Through wiring	With 5 conductors 2.5 mm ²
Drilled holes	3 x M25
Cable entries	2 x M25 Ø 7 – 17 mm
Material cable gland	Polyamide, black
Stopping plug	2 x M25 x 1.5
Stopping plug material	Polyamide, black
Accessories	Provided

Lighting

Linear luminaire For fluorescent lamps

GRP

6001/542-9510-15-131 Art. No. 220903



Dimensional Drawings (All Dimensions in mm [inches]) – Subject to Alterations

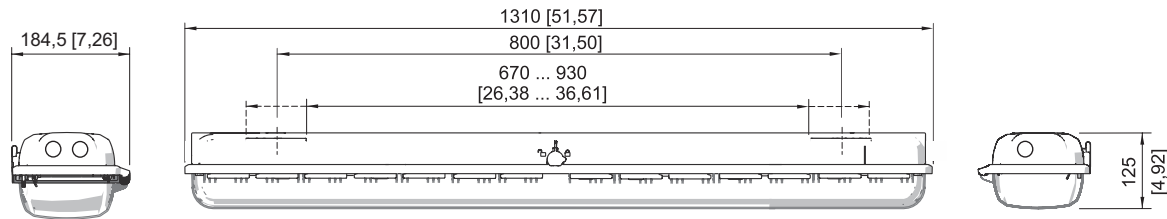

Size 4

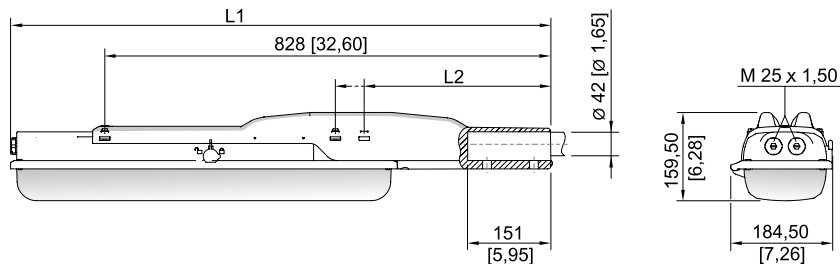

With pole mounting sleeve

Size 2:

L1 = 978 mm [38.50]

L2 = 390 mm [15.35]

Size 4:

L1 = 1587 mm [62.48]

L2 = 338 mm [13.31]

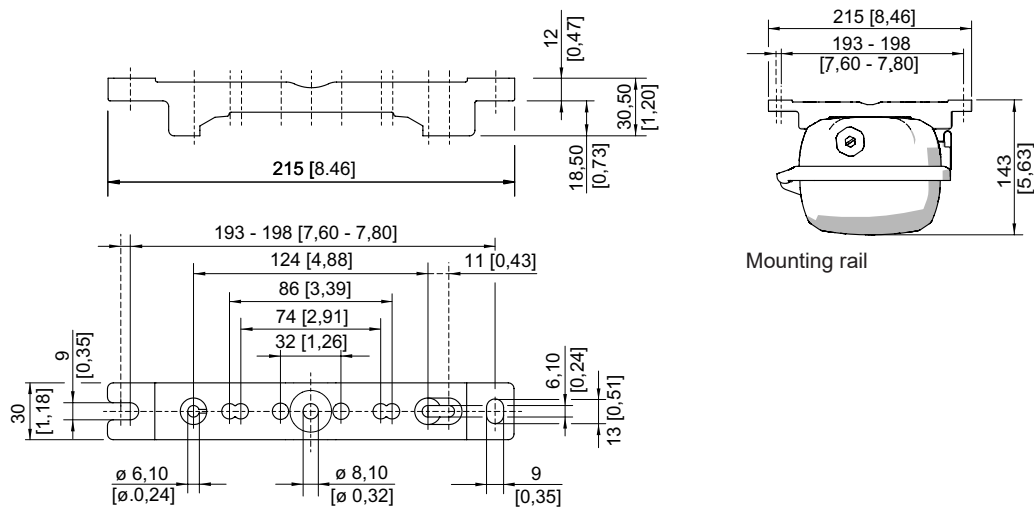

Mounting rail

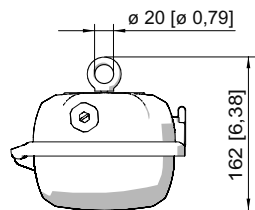

Ring bolt fitted in insert nut of the luminaire

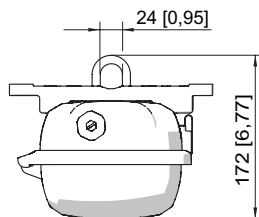

Mounting bracket fitted in mounting rail

Lighting

Linear luminaire For fluorescent lamps

GRP

6001/542-9510-15-131 Art. No. 220903

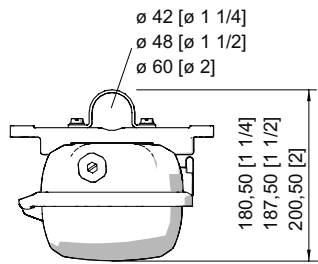

Pipe clamp fitted in mounting rail

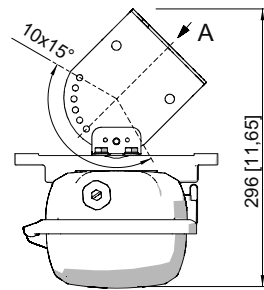

A

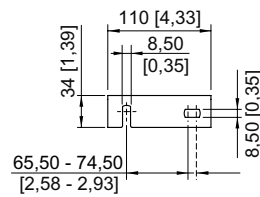

Wall mounting bracket fitted in mounting rail

Accessories

Breather

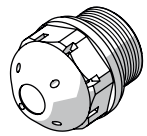

Thread: M25 x 1.5; 1 pc; for installation in lights; in moulded material; without counter nut
Thread: M25 x 1.5; 20 pc; for installation in lights; in moulded material; without counter nut

Art. No.

138573

138576

Ceiling and wall mounting bracket

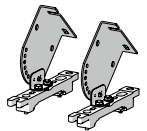

mounted on a mounting rail for a variable mounting distance; Material: stainless steel; Lamp can be swiveled in steps of 15°; 1 pair

Art. No.

222827

Mounting bracket

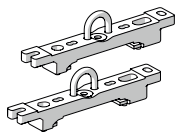

mounting clamp mounted on a mounting rail for a variable mounting distance; 1 pair

Art. No.

222456

Mounting rail

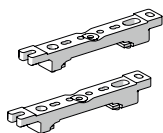

for a variable mounting distance; 1 pair

Art. No.

222826

Pipe clamp

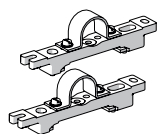

R 1 1/2"; with mounting rail for a variable mounting distance; Material: stainless steel; 1 pair
R 1 1/4"; with mounting rail for a variable mounting distance; Material: stainless steel; 1 pair
R 2"; with mounting rail for a variable mounting distance; Material: stainless steel; 1 pair

Art. No.

222459

222458

222460

Lighting

Linear luminaire For fluorescent lamps

GRP

6001/542-9510-15-131 Art. No. 220903



Pole mounting sleeve

Art. No.



for the subsequent mounting on lights size 2 and size 4, completely with assembly parts (for pipe diameter 42 mm)

227512

Ring bolt

Art. No.



M8, direct mounting in insert nuts; 1 pair

115736

Socket key

Art. No.

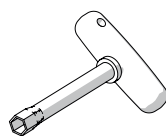

M8 / wrench size 13;
to open/close the central locking

222430

Spare Parts

Contact element

Art. No.

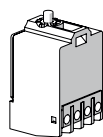

8080/1-3-L 2 NC contact element

132527

Cover

Art. No.

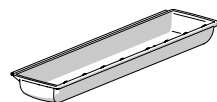

for luminaire size 4

222428

Fluorescent lamp

Art. No.

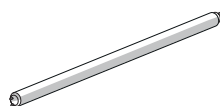

36 W, 3350 lm

108951

Lamp holder

Art. No.

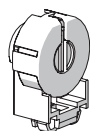

G13 Ex e lamp holder for light fittings with T8 fluorescent lamps for use in Zone 1

117252

We reserve the right to make alterations to the technical data, dimensions, weights, designs and products available without notice. The illustrations cannot be considered binding.