

wall mounting socket outlet, switched, interlocked and fused - housing dimensions 460x180, with fuse base D 02 and RCCB



| Product description | |
|---------------------------|-------------------------------------------------------------|
| BALS-Prd.-Nr | 17537 |
| EAN | 4024941175371 |
| Product category | TE wall mounting socket outlet switched, interlocked, fused |
| Current | 63A |
| Number of poles | 5p |
| Arrangement of phases | 3p+N+PE |
| Position of earth contact | 6 h |

| Product description | |
|------------------------|--------------------------------------------------------------------------------------------------------------------------------------------------------------------------|
| Voltage | 200/346 - 240/415V~ |
| Frequency | 50/60Hz |
| Protection degree | IP44 |
| Colour code | red RAL 3000 |
| Colour of appliance | Hinged lid red RAL 3000, Housing bottom grey RAL 7035, Housing screws grey RAL 7035, Housing top grey RAL 7035, Control knob grey RAL 7035, Operating window smoky topaz |
| Connection design | screw terminal as box terminal with Kontex-contact |
| Maximum conductor size | 25.0 qmm |
| Cable entry | top entry M40 bottom entry M40/M32 |
| Height | 500mm |
| Width | 180mm |
| Depth | 191mm |
| Dimension of enclosure | 460x180 mm (HxW) |
| Material of enclosure | Polycarbonate |
| Contacts | The contact carrier is made of high temperature resistant material, the contacts are brass nickel plated |

| Additional technical properties | |
|---------------------------------|--------------------------------------------------------------------|
| | The cable entry is one at top and two at bottom open |
| | In 0-position lockable for 4 padlocks with bow diameter up to 7 mm |
| | With fuse base 3 pole D02, with 4 pole 63/0.03A RCCB |

| Logistics data | |
|----------------|------------------|
| Weight/pcs | 4.045 kg / Piece |
| Packaging | Carton |
| Content amount | 1 ST |
| EAN | 4024941175371 |
| Length | 560 mm |
| Width | 215 mm |
| Height | 260 mm |
| Weight | 4.507 kg |
| Volume | 26,400 ccm |

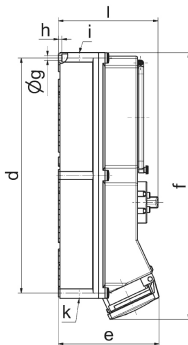
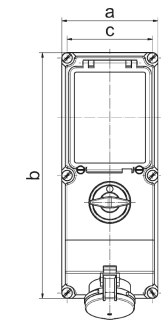

12 MB 53

| Ampere | 63 | 63 | 63 | | | | |
|----------------------------|--------|--------|--------|--|--|--|--|
| Polzahl | 3 | 4 | 5 | | | | |
| a | 180,0 | 180,0 | 180,0 | | | | |
| b | 460,0 | 460,0 | 460,0 | | | | |
| c | 160,0 | 160,0 | 160,0 | | | | |
| d | 440,0 | 440,0 | 440,0 | | | | |
| e | 184,0 | 184,0 | 184,0 | | | | |
| f | 500,0 | 500,0 | 500,0 | | | | |
| g ø | 8,3 | 8,3 | 8,3 | | | | |
| h | 6,5 | 6,5 | 6,5 | | | | |
| i | M40 | M40 | M40 | | | | |
| k | M40/32 | M40/32 | M40/32 | | | | |
| l | 189,0 | 189,0 | 189,0 | | | | |
| Leiter mm ² min | 6 | 6 | 6 | | | | |
| Leiter mm ² max | 25 | 25 | 25 | | | | |