

OPPLE
LIGHTING.

SMART LIGHTING



OPPLE.COM

OPPLE Smart Lighting System

Step into the lighting revolution with our fully upgraded BLE2 Smart Lighting portfolio. Powered by Bluetooth SIG Mesh, our products offer seamless integration and superior performance. Experience it today and transform your illumination.

Benefits:

- Industry standard wireless BLE protocol
- Improved OPPLE Smart App with more features
- Improved communication reliability
- Possibility to integrate 3rd party devices

With OPPLE Smart Lighting you can count on:

- Completely wireless control of lighting utilizing Bluetooth SIG Mesh
- Dynamic lighting without extra wiring
- Quick and easy installation, no need for a gateway
- Various scenes/moods can be set
- Maximum security thanks to coded signals and strict user management
- An excellent and affordable Smart Lighting system

* Note: BLE1 and BLE2 products cannot be mixed in the same Smart project, unless a BLE1 and a BLE2 Connect Box are both used.



Google
Play Store



Apple
App Store



Maximize energy savings with Smart Sensors

Discover the power of our smart sensors, designed to detect movement, lux levels, and humidity. Our Smart Lighting system seamlessly adjusts the lighting, ensuring maximized energy efficiency. Benefit from smart features such as daylight control, occupancy-based lighting adjustment, and automatic dimming in unoccupied spaces—ideal for corridors.

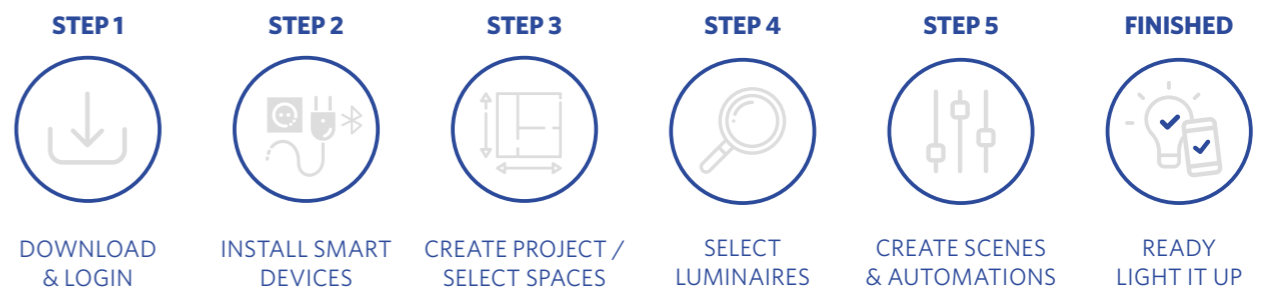

Available as Tunable White



- Varying colours in the same fixture
- Warm white to cool white (2700K - 6500K)
- Easy to install and control via the Smart Lighting system
- Healthcare and 24hrs applications

Compatible with 3rd party luminaires thanks to our Smart Converters

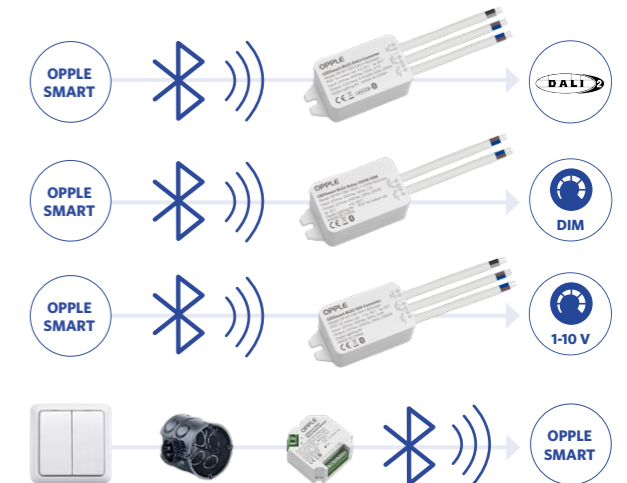

Easily integrate any existing luminaire, be it 1-10V, Triac or DALI2, into the Smart System with our converters.

Our compact Smart Multi Switch Module installs behind your existing wall switch, enabling effortless control of fixtures without the need for a separate switch or app. It's compatible with all Smart Luminaires.

Two smart solutions for all applications

1 Classic Smart Lighting System

Explore the convenience of our easy-to-set-up lighting solution, ideal for small to medium-sized applications. Control it effortlessly from your smartphone or tablet with our Smart App, putting the power of smart illumination at your fingertips. Transform your space with just a few taps and enjoy an user-friendly lighting experience.

The benefits

- Simple and fast
- Easy scene and automation setting
- Wireless sensors and switches
- Daylight control and corridor mode
- Independent from building

2 Smart Connect Box

Maximize the potential of our Smart Lighting System with the optional Smart Connect Box. This versatile gateway offers complete remote control, monitoring, and management capabilities, perfect for large multi-floor buildings. Experience the convenience and benefits of the Smart Connect Box and take full control of your lighting installation.

The benefits

- Maps out data clearly on energy consumption, temperature, humidity and occupancy detection for each building, floor and room.
- Always and everywhere in control: operate your building's lighting from a remote location.
- All DALI luminaires can be linked and operated via Smart Switch or Smart Sensor.
- Links multiple Smart Projects in a single project.
- Completely compatible with the existing OPPLE Smart Lighting system.
- Full logic configuration of the system (IFTTT rules) is possible.
- Scheduler: luminaire automatic on-/off switch at a specific time or date.
- Advanced features like Daylight Control and HCL application.
- Copy-paste function for Lighting scenes and automation rules from room to room.
- Possibility to integrate in Building Management Systems.

OPPLE "Classic" Smart Lighting vs Connect Box	"Classic" Smart Lighting system	Smart Connect Box system
Use of Smart Switch	✓	✓
Use of Smart Sensor	✓	✓
Daylight Control	✓	✓
Multiple managers/users per project	✓	✓
Show actual occupancy	✓	✓
Show actual temperature/humidity	✓	✓
Multiple installers per project	✓	✓
Human Centric Lighting	✗	✓
Control > 100 devices at once	✗	✓
Switch lighting at specific time/date	✗	✓
Control your lighting installation remotely	✗	✓
Energy use graph	✗	✓
Temperature/humidity graph	✗	✓
Occupancy graph per area	✗	✓



Energy consumption on everyone's agenda



Make the intelligent choice for energy consumption and sustainability. Embrace up to 60% energy savings by replacing conventional lighting with our extensive LED options including dimmable solutions like Dali, 1-10V, push dimming, or wireless Smart BLE. To achieve sustainability goals even more swiftly, make sure to incorporate the smart sensors. Let yourself be captivated by the possibilities of our scene and automation settings.

We're committed to providing comprehensive guidance and compliance support. Trust our expert lighting designers and account managers to offer tailored advice aligned with guidelines. Let us guide you to a sustainable future.

If you need advice, please don't hesitate to contact us.

OPPLE Human Centric Lighting

Bring The Sun Inside

With OPPLE's HCL feature people can now benefit from the natural daylight, inside.

HCL is a lighting design and application that improves our **psychological** and **physiological** states. This is especially important since we spend about 90% of our times without exposure to sunlight.

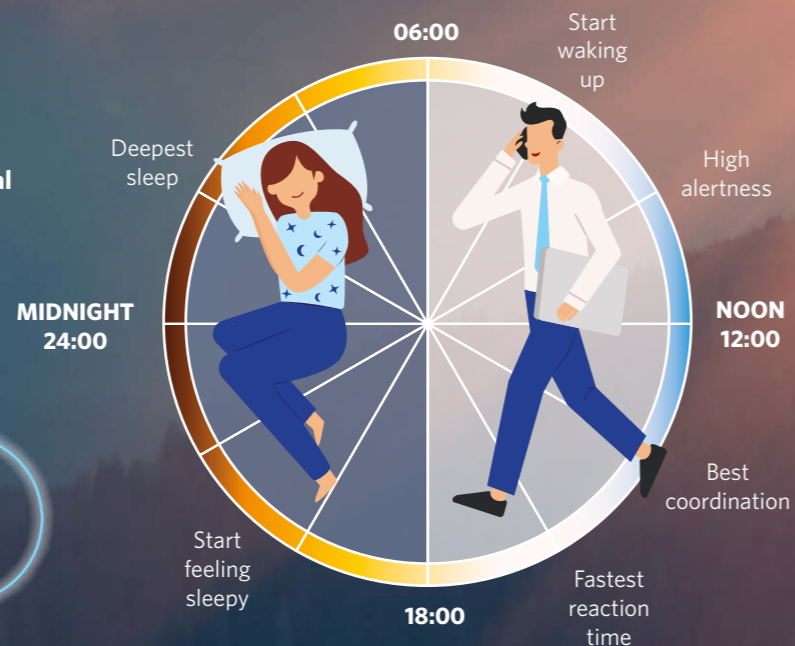

OPPLE offers a fully automated HCL system. It has never been easier to set up Human Centric Lighting!

- Choose from our preconfigured templates
- Full customization possible
- Available through the OPPLE Smart Connect Box
- No extra costs or subscription required

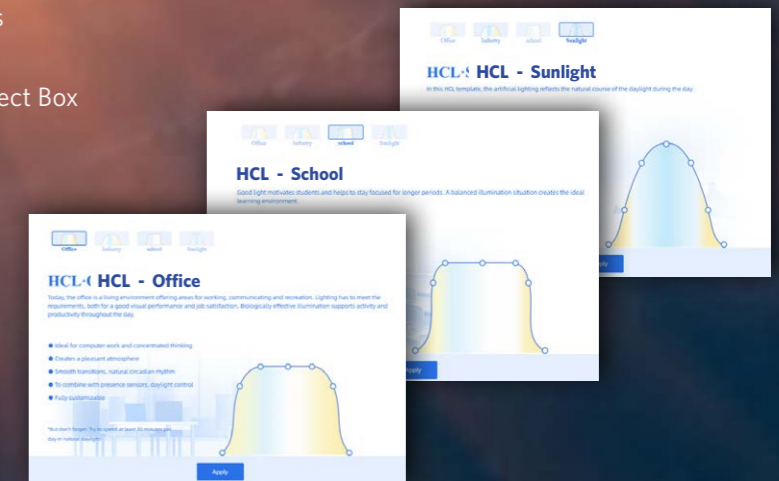

Full Portfolio available

Works with existing OPPLE SMART tunable white and dimmable luminaires.

Benefits of HCL and an improved circadian rhythm include:



Better wellbeing



Greater focus and alertness



Higher productivity



Enhanced sleeping quality

FULL HCL



HCL - Brightness only





OPPLE LIGHTING

Meerenakkerweg 1-07
5652 AR Eindhoven, The Netherlands

T +31 (0) 88 056 7888

E service@opple.com

OPPLE.COM